

axxess



All in one in-desk power and data management system. The AXXESS provides power & data solutions to your desktop, work station or boardroom table. It has been designed to allow cables to be stored within the unit while not in use. The lid sits flush when in use and the cables come out of the spring release lip. The unique locking arm system ensures that the AXXESS is securely fitted to the table/desk top by operating screws at each end of the AXXESS. Once fixed, the locking screws are covered with a screw cover.

Standard colour silver extrusion and grey endcaps with standard black POWERUNIT and data.

All **OE** Electrics products are manufactured to enable compliance with BS6396 where relevant. UK sockets incorporate fuses as standard with colour coded inserts indicating fuse rating. Unfused sockets may be specified where applicable.



USPs

- All-in-one power & data management solution
- Lid sits flush when in use
- Cable guides at either end guide cables to lip to avoid damage
- BS6396 compliant (where applicable)
- Fits into desk/tables with a thickness of 15-33mm
- Available with power sockets from different nationalities



technical

Common Modular Components*

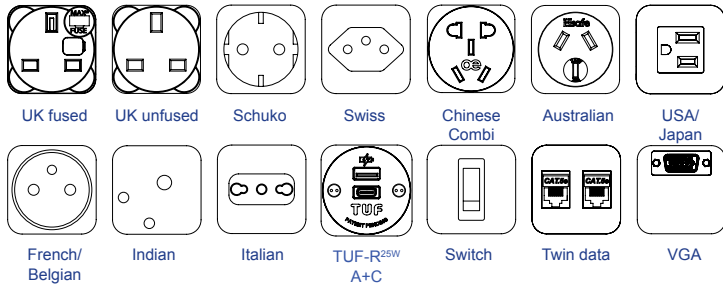

*See website for more

Features

Configuration:

Power only / Data only / Combined (Power & Data/AV)
Segregation between Power and Data/AV in combined AXCESS units

Earth Bonding:

A rewirable external earth terminal allows the removal/change of earth bondings leads without dismantling the unit.

Fusing: (to enable compliance to BS6396)

5 x 20mm anti-surge ceramic fuses, with colour-coded fuseclips to denote the rating (3.15A/5A)

Insulation:

Re-inforced insulation

Testing:

100% testing - continuity, polarity, insulation & earth

Soft Wiring (power)

Power via Wieland GST connector allows starter cables to be changed to suit requirements, especially useful during moves and changes (CHURN)

Soft Wired Data

As well as soft-wired power, AXCESS can accommodate soft wired data. Using our inline couplers, data cables can be changed "on-site" to accommodate changes in length often associated with churn

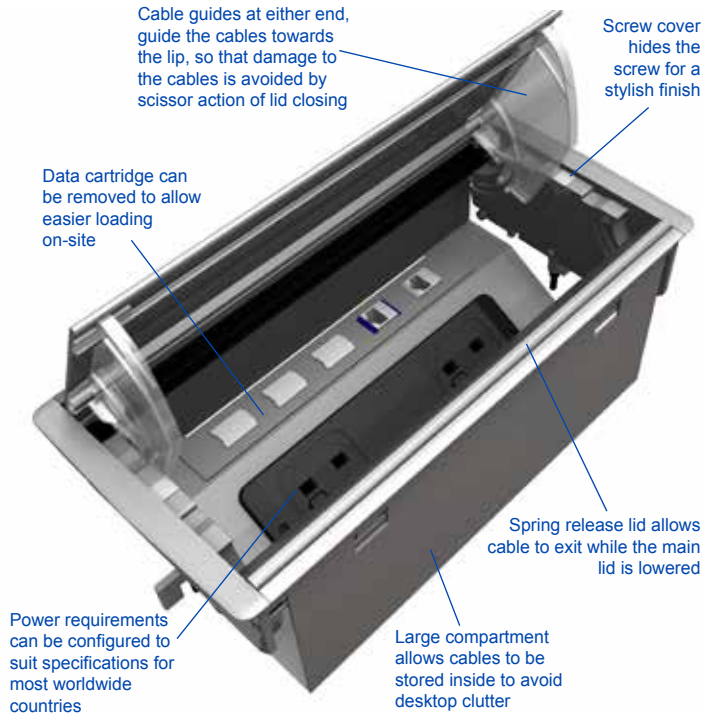

Unit Dimensions

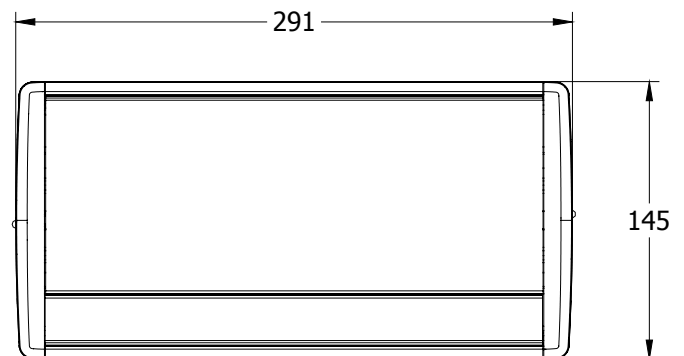

Cutout dimensions

